

Poly-V Pulleys

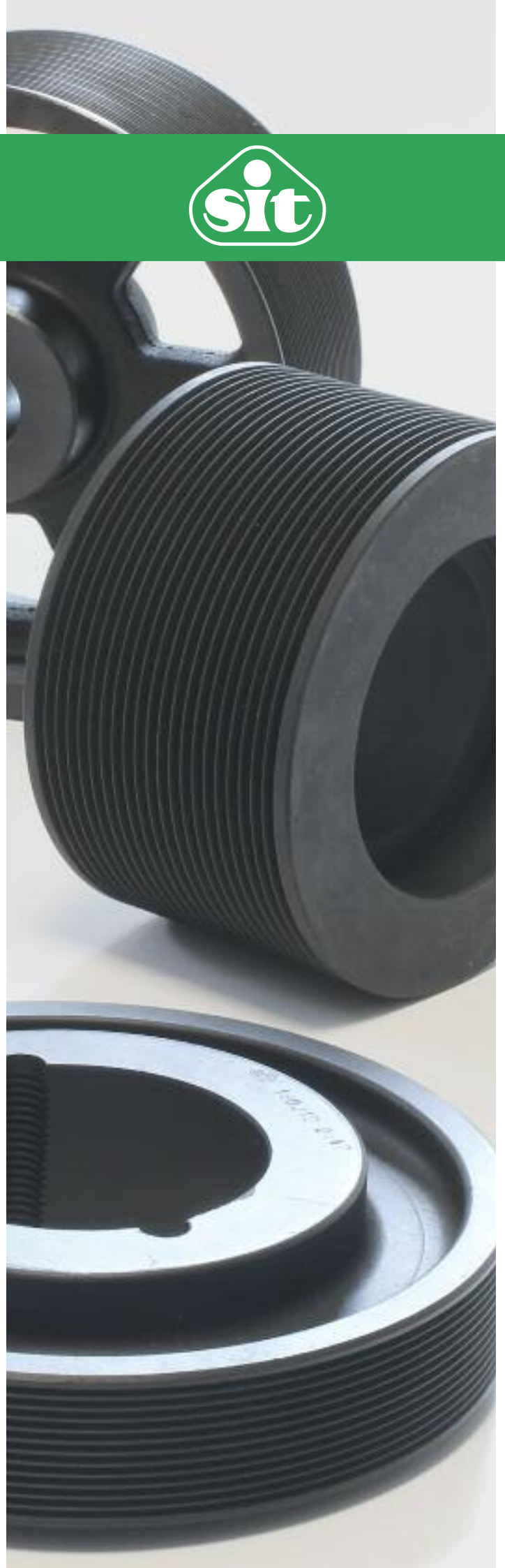

SIT Poly-V pulleys

SIT POLY-V pulleys are designed and manufactured with extreme accuracy to ensure optimal lifetime and performance of the transmission systems.

SIT is able to provide custom made solution to fulfil any specific technical requirement.

For mounting taper bushing SER-SIT®

Material: steel for diameters up to 50 mm
grey cast iron (GG25) for diameters exceeding 50 mm.
Finishing: protective surface treatment.

Sections:

- J
- K
- L
- M



Special executions

Besides the standard material on request are available special execution in aluminum, thermosetting plastics and thermoplastic. For peripheral speed exceeding 33 m/s it is strongly recommended to use steel as material of construction.

$$\text{peripheral speed [m/s]} = \frac{\text{pulley diameter [mm]} \cdot \text{rpm}}{19100}$$

Balancing

SIT Poly-V pulleys have a statically balanced degree of G6,3 at 1500 rpm in accordance with ISO 1940.

On request it is possible to perform static balancing at higher degrees or dynamic balancing.

GROOVES DIMENSIONS AND TOLERANCES

Complying with ISO 9982

| Section | α° | P [mm] | Tolerance of P [mm] | r_t min. [mm] | r_b max. [mm] | S min. [mm] | h [mm] |
|---------|----------------|-----------------|---------------------|-----------------|-----------------|-------------|--------|
| H | $40 \pm 0,5$ | $1,60 \pm 0,03$ | $\pm 0,03$ | 0,15 | 0,30 | 1,3 | 0,8 |
| J | $40 \pm 0,5$ | $2,34 \pm 0,03$ | $\pm 0,03$ | 0,20 | 0,40 | 1,8 | 1,2 |
| K | $40 \pm 0,5$ | $3,56 \pm 0,05$ | $\pm 0,03$ | 0,25 | 0,50 | 2,5 | 2,0 |
| L | $40 \pm 0,5$ | $4,70 \pm 0,05$ | $\pm 0,03$ | 0,40 | 0,40 | 3,3 | 3,0 |
| M | $40 \pm 0,5$ | $9,40 \pm 0,08$ | $\pm 0,03$ | 0,75 | 3,30 | 6,4 | 4,0 |

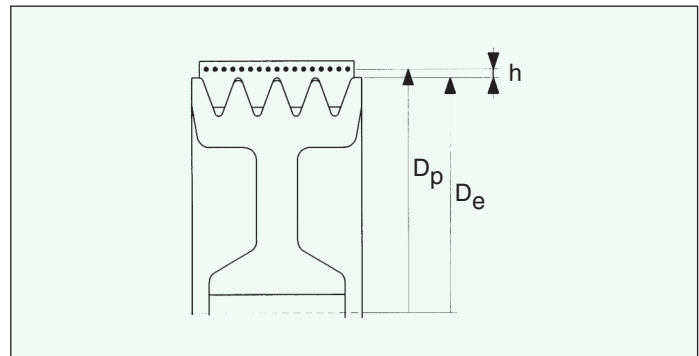
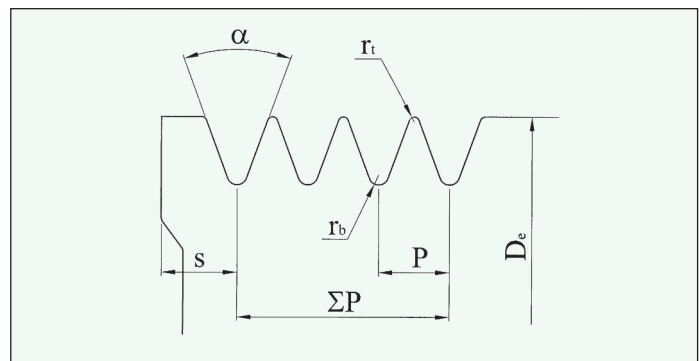

D_e = external diameter

D_p = pitch length

$h = (D_p - D_e)/2$

Note

Due to a constant improvement of our products, technical data of the pulleys may be subject to changes. For technical and production reasons, in some cases materials other than those indicated in the catalogue may be used. For confirmation of the material actually available, please contact customer service.

Dimensions of Poly-V pulleys - mounting taper bushing SER-SIT®

Pulleys with small diameter are supplied with solid hub execution prebored. (Ref. type 1)



“PYB” Poly-V “J”

| De [mm] | Number of grooves | Type | SER-SIT® Taper bushing | L [mm] | z [mm] | M [mm] | U [mm] | d [mm] | W [mm] |
|---------|-------------------|------|------------------------|--------|--------|--------|--------|--------|--------|
| 20 | 4 | 1 | - | 22,5 | - | - | - | 5,0 | 13,5 |
| | 8 | 1 | - | 32,0 | - | - | - | 5,0 | 23,0 |
| | 12 | 1 | - | 41,5 | - | - | - | 5,0 | 32,5 |
| | 16 | 1 | - | 51,0 | - | - | - | 5,0 | 42,0 |
| | 20 | 1 | - | 61,0 | - | - | - | 5,0 | 52,0 |
| 25 | 4 | 1 | - | 22,5 | - | - | - | 5,0 | 13,5 |
| | 8 | 1 | - | 32,0 | - | - | - | 5,0 | 23,0 |
| | 12 | 1 | - | 41,5 | - | - | - | 5,0 | 32,5 |
| | 16 | 1 | - | 51,0 | - | - | - | 5,0 | 42,0 |
| | 20 | 1 | - | 61,0 | - | - | - | 5,0 | 52,0 |
| 30 | 4 | 1 | - | 22,5 | - | - | - | 9,5 | 13,5 |
| | 8 | 1 | - | 32,0 | - | - | - | 9,5 | 23,0 |
| | 12 | 1 | - | 41,5 | - | - | - | 9,5 | 32,5 |
| | 16 | 1 | - | 51,0 | - | - | - | 9,5 | 42,0 |
| | 20 | 1 | - | 61,0 | - | - | - | 9,5 | 52,0 |
| 35 | 4 | 1 | - | 22,5 | - | - | - | 9,5 | 13,5 |
| | 8 | 1 | - | 32,0 | - | - | - | 9,5 | 23,0 |
| | 12 | 1 | - | 41,5 | - | - | - | 9,5 | 32,5 |
| | 16 | 1 | - | 51,0 | - | - | - | 9,5 | 42,0 |
| | 20 | 1 | - | 61,0 | - | - | - | 9,5 | 52,0 |
| 40 | 4 | 1 | - | 22,5 | - | - | - | 12,0 | 13,5 |
| | 8 | 1 | - | 32,0 | - | - | - | 12,0 | 23,0 |
| | 12 | 1 | - | 41,5 | - | - | - | 12,0 | 32,5 |
| | 16 | 1 | - | 51,0 | - | - | - | 12,0 | 42,0 |
| | 20 | 1 | - | 61,0 | - | - | - | 12,0 | 52,0 |
| 45 | 4 | 1 | - | 22,5 | - | - | - | 12,0 | 13,5 |
| | 8 | 1 | - | 32,0 | - | - | - | 12,0 | 23,0 |
| | 12 | 1 | - | 41,5 | - | - | - | 12,0 | 32,5 |
| | 16 | 1 | - | 51,0 | - | - | - | 12,0 | 42,0 |
| | 20 | 1 | - | 61,0 | - | - | - | 12,0 | 52,0 |
| 50 | 4 | 1 | - | 22,5 | - | - | - | 12,0 | 13,5 |
| | 8 | 1 | - | 32,0 | - | - | - | 12,0 | 23,0 |
| | 12 | 1 | - | 41,5 | - | - | - | 12,0 | 32,5 |
| | 16 | 1 | - | 51,0 | - | - | - | 12,0 | 42,0 |
| | 20 | 1 | - | 61,0 | - | - | - | 12,0 | 52,0 |
| 56 | 4 | 7 | 1108 | 23,0 | 9,5 | 50 | - | - | 13,5 |
| | 8 | 3 | 1108 | 23,0 | - | - | - | - | 23,0 |
| | 12 | 1 | - | 41,5 | - | - | - | 12,0 | 32,5 |
| | 16 | 1 | - | 51,0 | - | - | - | 12,0 | 42,0 |
| | 20 | 1 | - | 61,0 | - | - | - | 12,0 | 52,0 |
| 60 | 4 | 7 | 1108 | 23,0 | 9,5 | 50 | - | - | 13,5 |
| | 8 | 3 | 1108 | 23,0 | - | - | - | - | 23,0 |
| | 12 | 2 | 1108 | 23,0 | 9,5 | - | 45 | - | 32,5 |
| | 16 | 1 | - | 51,0 | - | - | - | 12,0 | 42,0 |
| | 20 | 1 | - | 61,0 | - | - | - | 12,0 | 52,0 |
| 63 | 4 | 7 | 1108 | 23,0 | 9,5 | 50 | - | - | 13,5 |
| | 8 | 3 | 1108 | 23,0 | - | - | - | - | 23,0 |
| | 12 | 2 | 1108 | 23,0 | 9,5 | - | 45 | - | 32,5 |
| | 16 | 1 | - | 51,0 | - | - | - | 12,0 | 42,0 |
| | 20 | 1 | - | 61,0 | - | - | - | 12,0 | 52,0 |
| 67 | 4 | 7 | 1108 | 23,0 | 9,5 | 50 | - | - | 13,5 |
| | 8 | 3 | 1108 | 23,0 | - | - | - | - | 23,0 |
| | 12 | 2 | 1108 | 23,0 | 9,5 | - | 51 | - | 32,5 |
| | 16 | 1 | - | 51,0 | - | - | - | 12,0 | 42,0 |
| | 20 | 1 | - | 61,0 | - | - | - | 12,0 | 52,0 |

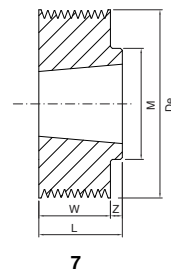
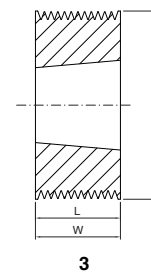
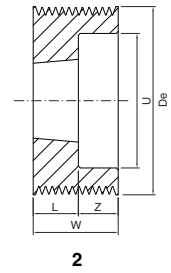
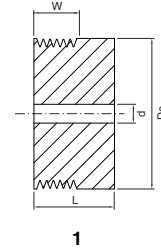

Part Number **PYB 200 J 8**

Poly-V pulley for taper bushing

External diameter in mm

Profile

Number of ribs

Dimensions of Poly-V pulleys - mounting taper bushing SER-SIT®



» “PYB” Poly-V “J”

| De [mm] | Number of grooves | Type | SER-SIT® Taper bushing | L [mm] | z [mm] | M [mm] | U [mm] | W [mm] |
|---------|-------------------|------|------------------------|--------|--------|--------|--------|--------|
| 71 | 4 | 7 | 1108 | 23 | 9,5 | 60 | - | 13,5 |
| | 8 | 3 | 1108 | 23 | - | - | - | 23,0 |
| | 12 | 2 | 1108 | 23 | 9,5 | - | 55 | 32,5 |
| | 16 | 3 | 1215 | 42 | - | - | 55 | 42,0 |
| | 20 | 2 | 1215 | 42 | 10,0 | - | 55 | 52,0 |
| 75 | 4 | 7 | 1108 | 23 | 9,5 | 60 | - | 13,5 |
| | 8 | 3 | 1108 | 23 | - | - | - | 23,0 |
| | 12 | 2 | 1210 | 26 | 6,5 | - | 59 | 32,5 |
| | 16 | 2 | 1610 | 26 | 16,0 | - | 59 | 42,0 |
| | 20 | 2 | 1615 | 42 | 10,0 | - | 59 | 52,0 |
| 80 | 4 | 7 | 1310 | 26 | 12,5 | 70 | - | 13,5 |
| | 8 | 7 | 1310 | 26 | 3,0 | 70 | - | 23,0 |
| | 12 | 2 | 1610 | 26 | 6,5 | - | 64 | 32,5 |
| | 16 | 2 | 1610 | 26 | 16,0 | - | 64 | 42,0 |
| | 20 | 2 | 1615 | 42 | 10,0 | - | 64 | 52,0 |
| 85 | 4 | 7 | 1310 | 26 | 12,5 | 70 | - | 13,5 |
| | 8 | 7 | 1310 | 26 | 3,0 | 70 | - | 23,0 |
| | 12 | 2 | 1610 | 26 | 6,5 | - | 69 | 32,5 |
| | 16 | 2 | 1610 | 26 | 16,0 | - | 69 | 42,0 |
| | 20 | 2 | 1615 | 42 | 10,0 | - | 69 | 52,0 |
| 90 | 4 | 7 | 1610 | 26 | 12,5 | 82 | - | 13,5 |
| | 8 | 7 | 1610 | 26 | 3,0 | 82 | - | 23,0 |
| | 12 | 2 | 1610 | 26 | 6,5 | - | 74 | 32,5 |
| | 16 | 2 | 1610 | 26 | 16,0 | - | 74 | 42,0 |
| | 20 | 2 | 1615 | 42 | 10,0 | - | 74 | 52,0 |
| 95 | 4 | 7 | 1610 | 26 | 12,5 | 82 | - | 13,5 |
| | 8 | 7 | 1610 | 26 | 3,0 | 82 | - | 23,0 |
| | 12 | 2 | 1610 | 26 | 6,5 | - | 79 | 32,5 |
| | 16 | 2 | 1610 | 26 | 16,0 | - | 79 | 42,0 |
| | 20 | 2 | 1615 | 42 | 10,0 | - | 79 | 52,0 |
| 100 | 4 | 7 | 1610 | 26 | 12,5 | 82 | - | 13,5 |
| | 8 | 7 | 1610 | 26 | 3,0 | 82 | - | 23,0 |
| | 12 | 2 | 1610 | 26 | 6,5 | - | 82 | 32,5 |
| | 16 | 2 | 1610 | 26 | 16,0 | - | 82 | 42,0 |
| | 20 | 2 | 1615 | 42 | 10,0 | - | 82 | 52,0 |
| 106 | 4 | 7 | 1610 | 26 | 12,5 | 88 | - | 13,5 |
| | 8 | 7 | 1610 | 26 | 3,0 | 88 | - | 23,0 |
| | 12 | 2 | 1610 | 26 | 6,5 | - | 88 | 32,5 |
| | 16 | 2 | 1610 | 26 | 16,0 | - | 88 | 42,0 |
| | 20 | 2 | 1615 | 42 | 10,0 | - | 88 | 52,0 |
| 112 | 4 | 7 | 1610 | 26 | 12,5 | 90 | - | 13,5 |
| | 8 | 7 | 1610 | 26 | 3,0 | 90 | - | 23,0 |
| | 12 | 2 | 1610 | 26 | 6,5 | - | 94 | 32,5 |
| | 16 | 2 | 1610 | 26 | 16,0 | - | 94 | 42,0 |
| | 20 | 2 | 1615 | 42 | 10,0 | - | 94 | 52,0 |
| 118 | 4 | 7 | 1610 | 26 | 12,5 | 90 | - | 13,5 |
| | 8 | 7 | 1610 | 26 | 3,0 | 90 | - | 23,0 |
| | 12 | 2 | 2012 | 32 | 0,5 | - | 98 | 32,5 |
| | 16 | 2 | 2012 | 32 | 10,0 | - | 98 | 42,0 |
| | 20 | 2 | 2012 | 32 | 20,0 | - | 98 | 52,0 |
| 125 | 4 | 8 | 1610 | 26 | 12,5 | 90 | 109 | 13,5 |
| | 8 | 8 | 1610 | 26 | 3,0 | 90 | 109 | 23,0 |
| | 12 | 2 | 2012 | 32 | 0,5 | - | 105 | 32,5 |
| | 16 | 2 | 2012 | 32 | 10,0 | - | 105 | 42,0 |
| | 20 | 2 | 2517 | 45 | 7,0 | - | 105 | 52,0 |

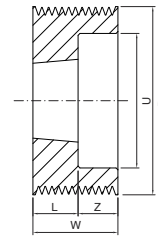

2

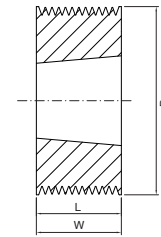

3

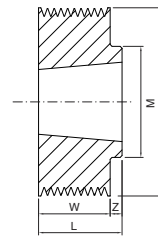

7

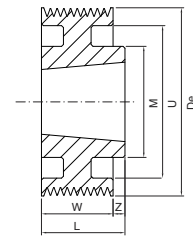

8

Dimensions of Poly-V pulleys - mounting taper bushing SER-SIT®



» “PYB” Poly-V “J”

| De [mm] | Number of grooves | Type | SER-SIT® Taper bushing | L [mm] | z [mm] | M [mm] | U [mm] | W [mm] |
|---------|-------------------|------|------------------------|--------|--------|--------|--------|--------|
| 132 | 4 | 8 | 1610 | 26 | 12,5 | 90 | 116 | 13,5 |
| | 8 | 8 | 1610 | 26 | 3,0 | 90 | 116 | 23,0 |
| | 12 | 2 | 2012 | 32 | 0,5 | - | 112 | 32,5 |
| | 16 | 2 | 2012 | 32 | 10,0 | - | 112 | 42,0 |
| | 20 | 2 | 2517 | 45 | 7,0 | - | 112 | 52,0 |
| 140 | 4 | 8 | 1610 | 26 | 12,5 | 90 | 124 | 13,5 |
| | 8 | 8 | 1610 | 26 | 3,0 | 90 | 124 | 23,0 |
| | 12 | 7 | 2517 | 45 | 12,5 | 120 | - | 32,5 |
| | 16 | 7 | 2517 | 45 | 3,0 | 120 | - | 42,0 |
| | 20 | 2 | 2517 | 45 | 7,0 | - | 124 | 52,0 |
| 160 | 4 | 8 | 2012 | 32 | 18,5 | 110 | 144 | 13,5 |
| | 8 | 8 | 2012 | 32 | 9,0 | 110 | 144 | 23,0 |
| | 12 | 8 | 2517 | 45 | 12,5 | 120 | 140 | 32,5 |
| | 16 | 8 | 2517 | 45 | 3,0 | 120 | 140 | 42,0 |
| | 20 | 2 | 2517 | 45 | 7,0 | - | 140 | 52,0 |
| 180 | 4 | 6 | 2012 | 32 | 9,3 | 110 | 164 | 13,5 |
| | 8 | 6 | 2012 | 32 | 4,5 | 110 | 164 | 23,0 |
| | 12 | 6 | 2517 | 45 | 6,3 | 120 | 160 | 32,5 |
| | 16 | 6 | 2517 | 45 | 1,5 | 120 | 160 | 42,0 |
| | 20 | 5 | 2517 | 45 | 3,5 | 120 | 160 | 52,0 |
| 200 | 4 | 6 | 2012 | 32 | 9,3 | 110 | 185 | 13,5 |
| | 8 | 6 | 2012 | 32 | 4,5 | 110 | 185 | 23,0 |
| | 12 | 6 | 2517 | 45 | 6,3 | 120 | 180 | 32,5 |
| | 16 | 6 | 2517 | 45 | 1,5 | 120 | 180 | 42,0 |
| | 20 | 5 | 2517 | 45 | 3,5 | 120 | 180 | 52,0 |
| 224 | 4 | 6 | 2012 | 32 | 9,3 | 110 | 208 | 13,5 |
| | 8 | 6 | 2012 | 32 | 4,5 | 110 | 208 | 23,0 |
| | 12 | 6 | 2517 | 45 | 6,3 | 120 | 204 | 32,5 |
| | 16 | 6 | 2517 | 45 | 1,5 | 120 | 204 | 42,0 |
| | 20 | 5 | 2517 | 45 | 3,5 | 120 | 204 | 52,0 |
| 250 | 4 | 9 | 2012 | 32 | 9,3 | 110 | 234 | 13,5 |
| | 8 | 9 | 2012 | 32 | 4,5 | 110 | 234 | 23,0 |
| | 12 | 6 | 2517 | 45 | 6,3 | 120 | 230 | 32,5 |
| | 16 | 6 | 2517 | 45 | 1,5 | 120 | 230 | 42,0 |
| | 20 | 5 | 2517 | 45 | 3,5 | 120 | 230 | 52,0 |
| 280 | 4 | 9 | 2012 | 32 | 9,3 | 110 | 264 | 13,5 |
| | 8 | 9 | 2012 | 32 | 4,5 | 110 | 264 | 23,0 |
| | 12 | 9 | 2517 | 45 | 6,3 | 120 | 260 | 32,5 |
| | 16 | 9 | 2517 | 45 | 1,5 | 120 | 260 | 42,0 |
| | 20 | 10 | 2517 | 45 | 3,5 | 120 | 260 | 52,0 |
| 315 | 4 | 9 | 2012 | 32 | 9,3 | 110 | 299 | 13,5 |
| | 8 | 9 | 2012 | 32 | 4,5 | 110 | 299 | 23,0 |
| | 12 | 9 | 2517 | 45 | 6,3 | 120 | 295 | 32,5 |
| | 16 | 9 | 2517 | 45 | 1,5 | 120 | 295 | 42,0 |
| | 20 | 10 | 2517 | 45 | 3,5 | 120 | 295 | 52,0 |
| 355 | 4 | 9 | 2517 | 45 | 15,7 | 120 | 339 | 13,5 |
| | 8 | 9 | 2517 | 45 | 11,0 | 120 | 339 | 23,0 |
| | 12 | 9 | 2517 | 45 | 6,3 | 120 | 335 | 32,5 |
| | 16 | 9 | 3020 | 52 | 5,0 | 146 | 335 | 42,0 |
| | 20 | 10 | 3020 | 52 | - | 146 | 335 | 52,0 |
| 400 | 4 | 9 | 2517 | 45 | 15,8 | 120 | 380 | 13,5 |
| | 8 | 9 | 2517 | 45 | 11,0 | 120 | 380 | 23,0 |
| | 12 | 9 | 2517 | 45 | 6,3 | 120 | 380 | 32,5 |
| | 16 | 9 | 3020 | 52 | 5,0 | 146 | 380 | 42,0 |
| | 20 | 10 | 3020 | 52 | - | 146 | 380 | 52,0 |

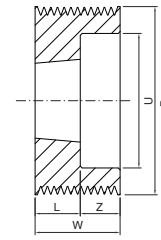

2

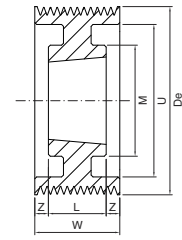

5

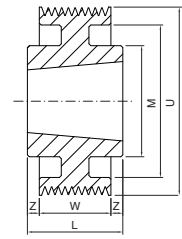

6

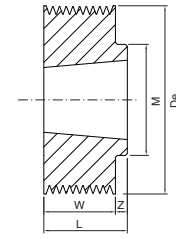

7

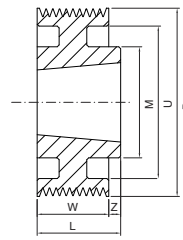

8

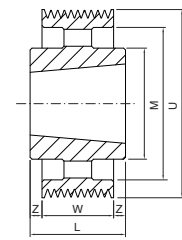

9

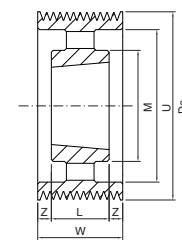

10

Dimensions of Poly-V pulleys - mounting taper bushing SER-SIT®



“PYB” Poly-V “K”

| De [mm] | Number of grooves | Type | SER-SIT® Taper bushing | L [mm] | z [mm] | M [mm] | U [mm] | d [mm] | W [mm] |
|---------|-------------------|------|------------------------|--------|--------|--------|--------|--------|--------|
| 50 | 4 | 1 | - | 32 | - | - | - | 12 | 20,5 |
| | 6 | 1 | - | 40 | - | - | - | 12 | 28,5 |
| | 8 | 1 | - | 48 | - | - | - | 12 | 36,0 |
| | 10 | 1 | - | 54 | - | - | - | 12 | 42,0 |
| | 12 | 1 | - | 61 | - | - | - | 12 | 49,0 |
| 56 | 4 | 3 | 1108 | 20,5 | - | - | - | - | 20,5 |
| | 6 | 1 | - | 40 | - | - | - | 12 | 28,5 |
| | 8 | 1 | - | 48 | - | - | - | 12 | 36,0 |
| | 10 | 1 | - | 54 | - | - | - | 12 | 42,0 |
| | 12 | 1 | - | 61 | - | - | - | 12 | 49,0 |
| 60 | 4 | 3 | 1108 | 20,5 | - | - | - | - | 20,5 |
| | 6 | 2 | 1108 | 22 | 6,5 | - | 45 | - | 28,5 |
| | 8 | 1 | - | 48 | - | - | - | 12 | 36,0 |
| | 10 | 1 | - | 54 | - | - | - | 12 | 42,0 |
| | 12 | 1 | - | 61 | - | - | - | 12 | 49,0 |
| 63 | 4 | 3 | 1108 | 20,5 | - | - | - | - | 20,5 |
| | 6 | 2 | 1108 | 22 | 6,5 | - | 48 | - | 28,5 |
| | 8 | 1 | - | 48 | - | - | - | 12 | 36,0 |
| | 10 | 1 | - | 54 | - | - | - | 12 | 42,0 |
| | 12 | 1 | - | 61 | - | - | - | 12 | 49,0 |
| 67 | 4 | 3 | 1108 | 20,5 | - | - | - | - | 20,5 |
| | 6 | 2 | 1108 | 22 | 6,5 | - | 51 | - | 28,5 |
| | 8 | 1 | - | 48 | - | - | - | 12 | 36,0 |
| | 10 | 1 | - | 54 | - | - | - | 12 | 42,0 |
| | 12 | 1 | - | 61 | - | - | - | 12 | 49,0 |
| 71 | 4 | 3 | 1108 | 20,5 | - | - | - | - | 20,5 |
| | 6 | 2 | 1108 | 23 | 6,5 | - | 55 | - | 28,5 |
| | 8 | 2 | 1210 | 26 | 10 | - | 55 | - | 36,0 |
| | 10 | 3 | 1215 | 42 | - | - | - | - | 42,0 |
| | 12 | 2 | 1215 | 42 | 7 | - | 55 | - | 49,0 |
| 75 | 4 | 3 | 1108 | 20,5 | - | - | - | - | 20,5 |
| | 6 | 2 | 1210 | 26 | 2,5 | - | 59 | - | 28,5 |
| | 8 | 2 | 1210 | 26 | 10 | - | 59 | - | 36,0 |
| | 10 | 3 | 1215 | 42 | - | - | - | - | 42,0 |
| | 12 | 2 | 1215 | 42 | 7 | - | 59 | - | 49,0 |
| 80 | 4 | 7 | 1210 | 26 | 5,5 | 70 | - | - | 20,5 |
| | 6 | 2 | 1210 | 26 | 2,5 | - | 64 | - | 28,5 |
| | 8 | 2 | 1210 | 26 | 10 | - | 64 | - | 36,0 |
| | 10 | 3 | 1215 | 42 | - | - | - | - | 42,0 |
| | 12 | 2 | 1215 | 42 | 7 | - | 64 | - | 49,0 |
| 85 | 4 | 7 | 1210 | 26 | 5,5 | 70 | - | - | 20,5 |
| | 6 | 2 | 1210 | 26 | 2,5 | - | 69 | - | 28,5 |
| | 8 | 2 | 1210 | 26 | 10 | - | 69 | - | 36,0 |
| | 10 | 3 | 1215 | 42 | - | - | - | - | 42,0 |
| | 12 | 2 | 1215 | 42 | 7 | - | 69 | - | 49,0 |
| 90 | 4 | 7 | 1210 | 26 | 5,5 | 82 | - | - | 20,5 |
| | 6 | 2 | 1210 | 26 | 2,5 | - | 74 | - | 28,5 |
| | 8 | 2 | 1210 | 26 | 10 | - | 74 | - | 36,0 |
| | 10 | 3 | 1215 | 42 | - | - | - | - | 42,0 |
| | 12 | 2 | 1215 | 42 | 7 | - | 74 | - | 49,0 |
| 95 | 4 | 7 | 1610 | 26 | 5,5 | 90 | - | - | 20,5 |
| | 6 | 2 | 1610 | 26 | 2,5 | - | 79 | - | 28,5 |
| | 8 | 2 | 1610 | 26 | 10 | - | 79 | - | 36,0 |
| | 10 | 3 | 1615 | 42 | - | - | - | - | 42,0 |
| | 12 | 2 | 1615 | 42 | 7 | - | 79 | - | 49,0 |
| 100 | 4 | 7 | 1610 | 26 | 5,5 | 90 | - | - | 20,5 |
| | 6 | 2 | 1610 | 26 | 2,5 | - | 82 | - | 28,5 |
| | 8 | 2 | 1610 | 26 | 10 | - | 82 | - | 36,0 |
| | 10 | 3 | 1615 | 42 | - | - | - | - | 42,0 |
| | 12 | 2 | 1615 | 42 | 7 | - | 82 | - | 49,0 |

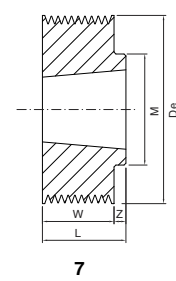
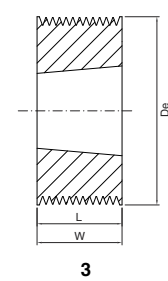
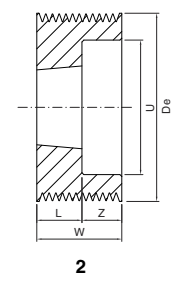
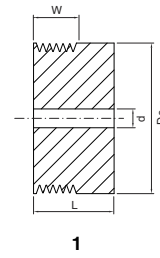

POLY-V PULLEYS - PYB

Dimensions of Poly-V pulleys - mounting taper bushing SER-SIT®



» “PYB” Poly-V “K”

| De [mm] | Number of grooves | Type | SER-SIT® Taper bushing | L [mm] | z [mm] | M [mm] | U [mm] | W [mm] |
|---------|-------------------|------|------------------------|--------|--------|--------|--------|--------|
| 106 | 4 | 7 | 1610 | 26 | 5,5 | 90 | - | 20,5 |
| | 6 | 2 | 1610 | 26 | 2,5 | - | 88 | 28,5 |
| | 8 | 2 | 1610 | 26 | 10 | - | 88 | 36,0 |
| | 10 | 3 | 1615 | 42 | - | - | - | 42,0 |
| | 12 | 2 | 1615 | 42 | 7 | - | 88 | 49,0 |
| 112 | 4 | 7 | 1610 | 26 | 5,5 | 90 | - | 20,5 |
| | 6 | 2 | 1610 | 26 | 2,5 | - | 94 | 28,5 |
| | 8 | 2 | 1610 | 26 | 10 | - | 94 | 36,0 |
| | 10 | 3 | 1615 | 42 | - | - | - | 42,0 |
| | 12 | 2 | 1615 | 42 | 7 | - | 94 | 49,0 |
| 118 | 4 | 7 | 1610 | 26 | 5,5 | 90 | - | 20,5 |
| | 6 | 7 | 2012 | 32 | 3,5 | 110 | - | 28,5 |
| | 8 | 2 | 2012 | 32 | 4 | - | 98 | 36,0 |
| | 10 | 2 | 2012 | 32 | 10 | - | 98 | 42,0 |
| | 12 | 2 | 2012 | 32 | 17 | - | 98 | 49,0 |
| 125 | 4 | 8 | 1610 | 26 | 5,5 | 90 | 109 | 20,5 |
| | 6 | 7 | 2012 | 32 | 3,5 | 110 | - | 28,5 |
| | 8 | 2 | 2012 | 32 | 4 | - | 105 | 36,0 |
| | 10 | 2 | 2012 | 32 | 10 | - | 105 | 42,0 |
| | 12 | 2 | 2517 | 45 | 4 | - | 105 | 49,0 |
| 132 | 4 | 8 | 1610 | 26 | 5,5 | 90 | 116 | 20,5 |
| | 6 | 7 | 2012 | 32 | 3,5 | 110 | - | 28,5 |
| | 8 | 2 | 2012 | 32 | 4 | - | 112 | 36,0 |
| | 10 | 2 | 2012 | 32 | 10 | - | 112 | 42,0 |
| | 12 | 2 | 2517 | 45 | 4 | - | 112 | 49,0 |
| 140 | 4 | 8 | 1610 | 26 | 5,5 | 90 | 124 | 20,5 |
| | 6 | 7 | 2517 | 45 | 16,5 | 120 | - | 28,5 |
| | 8 | 7 | 2517 | 45 | 9 | 120 | - | 36,0 |
| | 10 | 7 | 2517 | 45 | 3 | 120 | - | 42,0 |
| | 12 | 2 | 2517 | 45 | 4 | - | 124 | 49,0 |
| 150 | 4 | 8 | 1610 | 26 | 5,5 | 90 | 134 | 20,5 |
| | 6 | 7 | 2517 | 45 | 16,5 | 120 | - | 28,5 |
| | 8 | 7 | 2517 | 45 | 9 | 120 | - | 36,0 |
| | 10 | 7 | 2517 | 45 | 3 | 120 | - | 42,0 |
| | 12 | 2 | 2517 | 45 | 4 | - | 130 | 49,0 |
| 160 | 4 | 8 | 2012 | 32 | 11,5 | 110 | 144 | 20,5 |
| | 6 | 8 | 2517 | 45 | 16,5 | 120 | 140 | 28,5 |
| | 8 | 8 | 2517 | 45 | 9 | 120 | 140 | 36,0 |
| | 10 | 8 | 2517 | 45 | 3 | 120 | 140 | 42,0 |
| | 12 | 2 | 2517 | 45 | 4 | - | 140 | 49,0 |
| 170 | 4 | 8 | 2012 | 32 | 11,5 | 110 | 154 | 20,5 |
| | 6 | 8 | 2517 | 45 | 16,5 | 120 | 150 | 28,5 |
| | 8 | 8 | 2517 | 45 | 9 | 120 | 150 | 36,0 |
| | 10 | 7 | 2517 | 45 | 3 | 120 | 150 | 42,0 |
| | 12 | 2 | 2517 | 45 | 4 | - | 150 | 49,0 |
| 180 | 4 | 6 | 2012 | 32 | 5,75 | 110 | 164 | 20,5 |
| | 6 | 6 | 2517 | 45 | 8,25 | 120 | 160 | 28,5 |
| | 8 | 6 | 2517 | 45 | 4,5 | 120 | 160 | 36,0 |
| | 10 | 6 | 2517 | 45 | 1,5 | 120 | 160 | 42,0 |
| | 12 | 5 | 2517 | 45 | 2 | 120 | 160 | 49,0 |
| 190 | 4 | 6 | 2012 | 32 | 5,75 | 110 | 174 | 20,5 |
| | 6 | 6 | 2517 | 45 | 8,25 | 120 | 170 | 28,5 |
| | 8 | 6 | 2517 | 45 | 4,5 | 120 | 170 | 36,0 |
| | 10 | 6 | 2517 | 45 | 1,5 | 120 | 170 | 42,0 |
| | 12 | 5 | 2517 | 45 | 2 | 120 | 170 | 49,0 |
| 200 | 4 | 6 | 2012 | 32 | 5,75 | 110 | 184 | 20,5 |
| | 6 | 6 | 2517 | 45 | 8,25 | 120 | 180 | 28,5 |
| | 8 | 6 | 2517 | 45 | 4,5 | 120 | 180 | 36,0 |
| | 10 | 6 | 2517 | 45 | 1,5 | 120 | 180 | 42,0 |
| | 12 | 5 | 2517 | 45 | 2 | 120 | 180 | 49,0 |

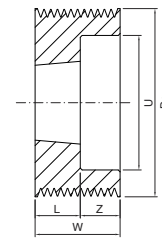

2

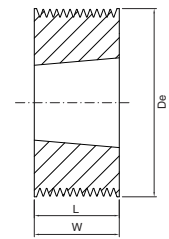

3

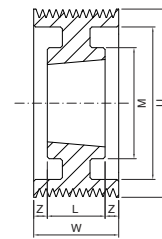

5

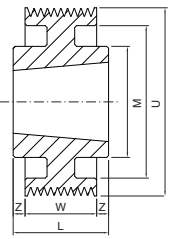

6

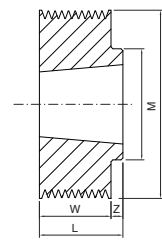

7

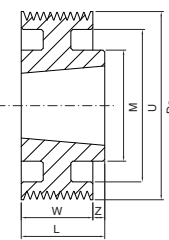

8

Dimensions of Poly-V pulleys - mounting taper bushing SER-SIT®



» “PYB” Poly-V “K”

| De [mm] | Number of grooves | Type | SER-SIT® Taper bushing | L [mm] | z [mm] | M [mm] | U [mm] | W [mm] |
|---------|-------------------|------|------------------------|--------|--------|--------|--------|--------|
| 212 | 4 | 6 | 2012 | 32 | 5,75 | 110 | 196 | 20,5 |
| | 6 | 6 | 2517 | 45 | 8,25 | 120 | 192 | 28,5 |
| | 8 | 6 | 2517 | 45 | 4,5 | 120 | 192 | 36,0 |
| | 10 | 6 | 2517 | 45 | 1,5 | 120 | 192 | 42,0 |
| | 12 | 5 | 2517 | 45 | 2 | 120 | 192 | 49,0 |
| 224 | 4 | 6 | 2012 | 32 | 5,75 | 110 | 208 | 20,5 |
| | 6 | 6 | 2517 | 45 | 8,25 | 120 | 204 | 28,5 |
| | 8 | 6 | 2517 | 45 | 4,5 | 120 | 204 | 36,0 |
| | 10 | 6 | 2517 | 45 | 1,5 | 120 | 204 | 42,0 |
| | 12 | 5 | 2517 | 45 | 2 | 120 | 204 | 49,0 |
| 236 | 4 | 6 | 2012 | 32 | 5,75 | 110 | 220 | 20,5 |
| | 6 | 6 | 2517 | 45 | 8,25 | 120 | 216 | 28,5 |
| | 8 | 6 | 2517 | 45 | 4,5 | 120 | 216 | 36,0 |
| | 10 | 6 | 2517 | 45 | 1,5 | 120 | 216 | 42,0 |
| | 12 | 5 | 2517 | 45 | 2 | 120 | 216 | 49,0 |
| 250 | 4 | 9 | 2012 | 32 | 5,75 | 110 | 234 | 20,5 |
| | 6 | 6 | 2517 | 45 | 8,25 | 120 | 230 | 28,5 |
| | 8 | 6 | 2517 | 45 | 4,5 | 120 | 230 | 36,0 |
| | 10 | 6 | 2517 | 45 | 1,5 | 120 | 230 | 42,0 |
| | 12 | 5 | 2517 | 45 | 2 | 120 | 230 | 49,0 |
| 280 | 4 | 9 | 2012 | 32 | 5,75 | 110 | 264 | 20,5 |
| | 6 | 9 | 2517 | 45 | 8,25 | 120 | 260 | 28,5 |
| | 8 | 9 | 2517 | 45 | 4,5 | 120 | 260 | 36,0 |
| | 10 | 9 | 3020 | 52 | 5 | 146 | 256 | 42,0 |
| | 12 | 9 | 3020 | 52 | 1,5 | 146 | 256 | 49,0 |
| 315 | 4 | 9 | 2012 | 32 | 5,75 | 110 | 299 | 20,5 |
| | 6 | 9 | 2517 | 45 | 8,25 | 120 | 295 | 28,5 |
| | 8 | 9 | 2517 | 45 | 4,5 | 120 | 295 | 36,0 |
| | 10 | 9 | 3020 | 52 | 5 | 146 | 285 | 42,0 |
| | 12 | 9 | 3020 | 52 | 1,5 | 146 | 285 | 49,0 |
| 355 | 4 | 9 | 2517 | 45 | 12,25 | 120 | 339 | 20,5 |
| | 6 | 9 | 2517 | 45 | 8,25 | 120 | 339 | 28,5 |
| | 8 | 9 | 3020 | 52 | 8 | 146 | 335 | 36,0 |
| | 10 | 9 | 3020 | 52 | 5 | 146 | 335 | 42,0 |
| | 12 | 9 | 3020 | 52 | 1,5 | 146 | 335 | 49,0 |
| 400 | 4 | 9 | 2517 | 45 | 2,25 | 120 | 380 | 20,5 |
| | 6 | 9 | 2517 | 45 | 8,25 | 120 | 380 | 28,5 |
| | 8 | 9 | 3020 | 52 | 8 | 146 | 370 | 36,0 |
| | 10 | 9 | 3020 | 52 | 5 | 146 | 370 | 42,0 |
| | 12 | 9 | 3020 | 52 | 1,5 | 146 | 370 | 49,0 |
| 450 | 4 | 9 | 2517 | 45 | 12,25 | 120 | 420 | 20,5 |
| | 6 | 9 | 2517 | 45 | 8,25 | 120 | 420 | 28,5 |
| | 8 | 9 | 3020 | 52 | 8 | 146 | 420 | 36,0 |
| | 10 | 9 | 3020 | 52 | 5 | 146 | 420 | 42,0 |
| | 12 | 9 | 3020 | 52 | 1,5 | 146 | 420 | 49,0 |
| 500 | 4 | 9 | 2517 | 45 | 12,25 | 120 | 470 | 20,5 |
| | 6 | 9 | 2517 | 45 | 8,25 | 120 | 470 | 28,5 |
| | 8 | 9 | 3020 | 52 | 8 | 146 | 470 | 36,0 |
| | 10 | 9 | 3020 | 52 | 5 | 146 | 470 | 42,0 |
| | 12 | 9 | 3020 | 52 | 1,5 | 146 | 470 | 49,0 |

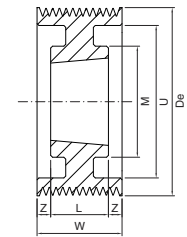

5

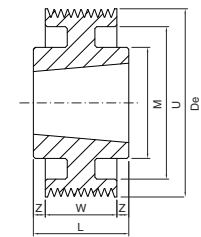

6

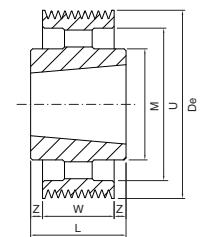

9

Dimensions of Poly-V pulleys - mounting taper bushing SER-SIT®



“PYB” Poly-V “L”

| De [mm] | Number of grooves | Type | SER-SIT® Taper bushing | L [mm] | z [mm] | U [mm] | W [mm] |
|---------|-------------------|------|------------------------|--------|--------|--------|--------|
| 75 | 6 | 2 | 1210 | 26 | 12,5 | 56 | 38,5 |
| | 8 | 2 | 1210 | 26 | 22 | 56 | 48,0 |
| | 10 | 2 | 1215 | 42 | 15 | 56 | 57,0 |
| | 12 | 2 | 1215 | 42 | 25 | 56 | 67,0 |
| 80 | 6 | 2 | 1210 | 26 | 12,5 | 56 | 38,5 |
| | 8 | 2 | 1210 | 26 | 22 | 56 | 48,0 |
| | 10 | 2 | 1215 | 42 | 15 | 56 | 57,0 |
| | 12 | 2 | 1215 | 42 | 25 | 56 | 67,0 |
| 85 | 6 | 2 | 1210 | 26 | 12,5 | 61 | 38,5 |
| | 8 | 2 | 1210 | 26 | 22 | 61 | 48,0 |
| | 10 | 2 | 1215 | 42 | 15 | 61 | 57,0 |
| | 12 | 2 | 1215 | 42 | 25 | 61 | 67,0 |
| 90 | 6 | 2 | 1210 | 26 | 12,5 | 66 | 38,5 |
| | 8 | 2 | 1210 | 26 | 22 | 66 | 48,0 |
| | 10 | 2 | 1215 | 42 | 15 | 66 | 57,0 |
| | 12 | 2 | 1215 | 42 | 25 | 66 | 67,0 |
| 95 | 6 | 2 | 1210 | 26 | 12,5 | 71 | 38,5 |
| | 8 | 2 | 1210 | 26 | 22 | 71 | 48,0 |
| | 10 | 2 | 1215 | 42 | 15 | 71 | 57,0 |
| | 12 | 2 | 1215 | 42 | 25 | 71 | 67,0 |
| 100 | 6 | 2 | 1610 | 26 | 12,5 | 76 | 38,5 |
| | 8 | 2 | 1610 | 26 | 22 | 76 | 48,0 |
| | 10 | 2 | 2012 | 32 | 25 | 79 | 57,0 |
| | 12 | 2 | 2012 | 32 | 35 | 79 | 67,0 |
| 106 | 6 | 2 | 1610 | 26 | 12,5 | 82 | 38,5 |
| | 8 | 2 | 1610 | 26 | 22 | 82 | 48,0 |
| | 10 | 2 | 2012 | 32 | 25 | 82 | 57,0 |
| | 12 | 2 | 2012 | 32 | 35 | 82 | 67,0 |
| 112 | 6 | 2 | 1610 | 26 | 12,5 | 88 | 38,5 |
| | 8 | 2 | 1610 | 26 | 22 | 88 | 48,0 |
| | 10 | 2 | 2012 | 32 | 25 | 88 | 57,0 |
| | 12 | 2 | 2012 | 32 | 35 | 88 | 67,0 |
| 118 | 6 | 2 | 2012 | 32 | 6,5 | 94 | 38,5 |
| | 8 | 2 | 2012 | 32 | 16 | 94 | 48,0 |
| | 10 | 4 | 2517 | 45 | 6 | 97 | 57,0 |
| | 12 | 4 | 2517 | 45 | 11 | 97 | 67,0 |
| 125 | 6 | 2 | 2012 | 32 | 6,5 | 101 | 38,5 |
| | 8 | 2 | 2012 | 32 | 16 | 101 | 48,0 |
| | 10 | 4 | 2517 | 45 | 6 | 101 | 57,0 |
| | 12 | 4 | 2517 | 45 | 11 | 101 | 67,0 |
| 132 | 6 | 2 | 2012 | 32 | 6,5 | 108 | 38,5 |
| | 8 | 2 | 2012 | 32 | 16 | 108 | 48,0 |
| | 10 | 4 | 2517 | 45 | 6 | 108 | 57,0 |
| | 12 | 4 | 2517 | 45 | 11 | 108 | 67,0 |
| 140 | 6 | 2 | 2517 | 45 | 20,5 | 108 | 86,0 |
| | 8 | 2 | 2517 | 45 | 30 | 108 | 105,0 |
| | 10 | 4 | 2517 | 45 | 6 | 108 | 57,0 |
| | 12 | 4 | 2517 | 45 | 11 | 108 | 67,0 |
| 150 | 6 | 2 | 2517 | 45 | 20,5 | 108 | 86,0 |
| | 8 | 2 | 2517 | 45 | 30 | 108 | 105,0 |
| | 10 | 4 | 2517 | 45 | 6 | 108 | 57,0 |
| | 12 | 4 | 2517 | 45 | 11 | 108 | 67,0 |

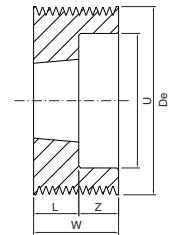

2

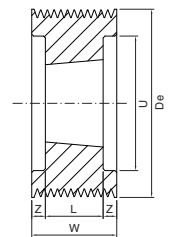

4

Dimensions of Poly-V pulleys - mounting taper bushing SER-SIT®



» “PYB” Poly-V “L”

| De [mm] | Number of grooves | Type | SER-SIT® Taper bushing | L [mm] | z [mm] | M [mm] | U [mm] | W [mm] |
|---------|-------------------|------|------------------------|--------|--------|--------|--------|--------|
| 140 | 6 | 7 | 2517 | 45 | 6,5 | 120 | - | 38,5 |
| | 8 | 2 | 2517 | 45 | 3 | - | 116 | 48,0 |
| | 10 | 4 | 2517 | 45 | 6 | - | 116 | 57,0 |
| | 12 | 4 | 2517 | 45 | 11 | - | 116 | 67,0 |
| | 16 | 4 | 2517 | 45 | 20,5 | - | 116 | 86,0 |
| | 20 | 4 | 3020 | 52 | 26,5 | - | 116 | 105,0 |
| 150 | 6 | 7 | 2517 | 45 | 6,5 | 120 | - | 38,5 |
| | 8 | 2 | 2517 | 45 | 3 | - | 126 | 48,0 |
| | 10 | 4 | 2517 | 45 | 6 | - | 126 | 57,0 |
| | 12 | 4 | 2517 | 45 | 11 | - | 126 | 67,0 |
| | 16 | 4 | 2517 | 45 | 20,5 | - | 126 | 86,0 |
| | 20 | 4 | 3020 | 52 | 26,5 | - | 126 | 105,0 |
| 160 | 6 | 7 | 2517 | 45 | 6,5 | 120 | - | 38,5 |
| | 8 | 2 | 2517 | 45 | 3 | - | 136 | 48,0 |
| | 10 | 4 | 2517 | 45 | 6 | - | 136 | 57,0 |
| | 12 | 4 | 2517 | 45 | 11 | - | 136 | 67,0 |
| | 16 | 4 | 3020 | 52 | 17 | - | 136 | 86,0 |
| | 20 | 4 | 3020 | 52 | 26,5 | - | 136 | 105,0 |
| 170 | 6 | 8 | 2517 | 45 | 6,5 | 120 | 146 | 38,5 |
| | 8 | 2 | 2517 | 45 | 3 | - | 146 | 48,0 |
| | 10 | 4 | 2517 | 45 | 6 | - | 146 | 57,0 |
| | 12 | 4 | 2517 | 45 | 11 | - | 146 | 67,0 |
| | 16 | 4 | 3020 | 52 | 17 | - | 146 | 86,0 |
| | 20 | 4 | 3020 | 52 | 26,5 | - | 146 | 105,0 |
| 180 | 6 | 6 | 2517 | 45 | 3,25 | 120 | 156 | 38,5 |
| | 8 | 5 | 2517 | 45 | 1,5 | 120 | 156 | 48,0 |
| | 10 | 5 | 2517 | 45 | 6 | 120 | 156 | 57,0 |
| | 12 | 5 | 2517 | 45 | 11 | 120 | 156 | 67,0 |
| | 16 | 4 | 3020 | 52 | 17 | - | 156 | 86,0 |
| | 20 | 4 | 3020 | 52 | 26,5 | - | 156 | 105,0 |
| 190 | 6 | 6 | 2517 | 45 | 3,25 | 120 | 166 | 38,5 |
| | 8 | 5 | 2517 | 45 | 1,5 | 120 | 166 | 48,0 |
| | 10 | 5 | 2517 | 45 | 6 | 120 | 166 | 57,0 |
| | 12 | 5 | 2517 | 45 | 11 | 120 | 166 | 67,0 |
| | 16 | 4 | 3020 | 52 | 17 | 146 | 166 | 86,0 |
| | 20 | 4 | 3020 | 52 | 26,5 | 146 | 166 | 105,0 |
| 200 | 6 | 6 | 2517 | 45 | 3,25 | 120 | 176 | 38,5 |
| | 8 | 5 | 2517 | 45 | 1,5 | 120 | 176 | 48,0 |
| | 10 | 4 | 3020 | 52 | 2,5 | 146 | 176 | 57,0 |
| | 12 | 4 | 3020 | 52 | 7,5 | 146 | 176 | 67,0 |
| | 16 | 4 | 3020 | 52 | 17 | 146 | 176 | 86,0 |
| | 20 | 4 | 3535 | 89 | 8 | - | 176 | 105,0 |
| 212 | 6 | 6 | 2517 | 45 | 3,25 | 120 | 188 | 38,5 |
| | 8 | 5 | 2517 | 45 | 1,5 | 120 | 188 | 48,0 |
| | 10 | 4 | 3020 | 52 | 2,5 | 146 | 188 | 57,0 |
| | 12 | 4 | 3020 | 52 | 7,5 | 146 | 188 | 67,0 |
| | 16 | 4 | 3020 | 52 | 17 | 146 | 188 | 86,0 |
| | 20 | 4 | 3535 | 89 | 8 | - | 188 | 105,0 |
| 224 | 6 | 6 | 2517 | 45 | 3,25 | 120 | 202 | 38,5 |
| | 8 | 5 | 2517 | 45 | 1,5 | 120 | 202 | 48,0 |
| | 10 | 5 | 3020 | 52 | 2,5 | 146 | 202 | 57,0 |
| | 12 | 5 | 3020 | 52 | 7,5 | 146 | 202 | 67,0 |
| | 16 | 5 | 3020 | 52 | 17 | 146 | 202 | 86,0 |
| | 20 | 5 | 3535 | 89 | 8 | 178 | 202 | 105,0 |
| 236 | 6 | 6 | 2517 | 45 | 3,25 | 120 | 214 | 38,5 |
| | 8 | 5 | 2517 | 45 | 1,5 | 120 | 214 | 48,0 |
| | 10 | 5 | 3020 | 52 | 2,5 | 146 | 214 | 57,0 |
| | 12 | 5 | 3020 | 52 | 7,5 | 146 | 214 | 67,0 |
| | 16 | 5 | 3020 | 52 | 17 | 146 | 214 | 86,0 |
| | 20 | 5 | 3535 | 89 | 8 | 178 | 214 | 105,0 |

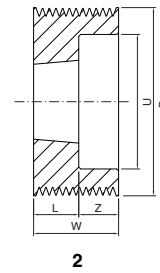

2

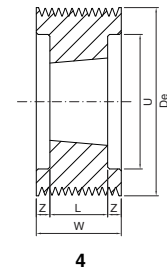

4

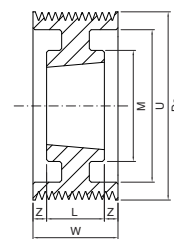

5

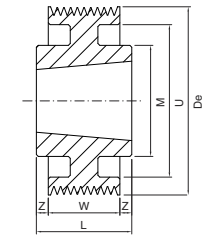

6

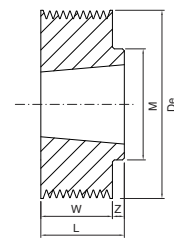

7

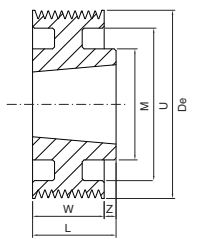

8

Dimensions of Poly-V pulleys - mounting taper bushing SER-SIT®



» "PYB" Poly-V "L"

| De [mm] | Number of grooves | Type | SER-SIT® Taper bushing | L [mm] | z [mm] | M [mm] | U [mm] | W [mm] |
|---------|-------------------|------|------------------------|--------|--------|--------|--------|--------|
| 250 | 6 | 9 | 2517 | 45 | 3,25 | 120 | 228 | 38,5 |
| | 8 | 5 | 2517 | 45 | 1,5 | 120 | 228 | 48,0 |
| | 10 | 5 | 3020 | 52 | 2,5 | 146 | 228 | 57,0 |
| | 12 | 5 | 3020 | 52 | 7,5 | 146 | 228 | 67,0 |
| | 16 | 5 | 3020 | 52 | 17 | 146 | 228 | 86,0 |
| | 20 | 5 | 3535 | 89 | 8 | 178 | 226 | 105,0 |
| 280 | 6 | 9 | 2517 | 45 | 3,25 | 120 | 256 | 38,5 |
| | 8 | 6 | 3020 | 52 | 2 | 146 | 256 | 48,0 |
| | 10 | 5 | 3020 | 52 | 2,5 | 146 | 256 | 57,0 |
| | 12 | 5 | 3020 | 52 | 7,5 | 146 | 256 | 67,0 |
| | 16 | 6 | 3535 | 89 | 1,5 | 178 | 256 | 86,0 |
| | 20 | 5 | 3535 | 89 | 8 | 178 | 256 | 105,0 |
| 315 | 6 | 9 | 2517 | 45 | 3,25 | 120 | 285 | 38,5 |
| | 8 | 9 | 3020 | 52 | 2 | 146 | 285 | 48,0 |
| | 10 | 6 | 3535 | 89 | 16 | 178 | 285 | 57,0 |
| | 12 | 6 | 3535 | 89 | 11 | 178 | 285 | 67,0 |
| | 16 | 6 | 3535 | 89 | 1,5 | 178 | 285 | 86,0 |
| | 20 | 5 | 4040 | 102 | 1,5 | 215 | 285 | 105,0 |
| 355 | 6 | 9 | 3020 | 52 | 6,75 | 146 | 325 | 38,5 |
| | 8 | 9 | 3020 | 52 | 2 | 146 | 325 | 48,0 |
| | 10 | 9 | 3535 | 89 | 16 | 178 | 325 | 57,0 |
| | 12 | 9 | 3535 | 89 | 11 | 178 | 325 | 67,0 |
| | 16 | 9 | 3535 | 89 | 1,5 | 178 | 325 | 86,0 |
| | 20 | 5 | 4040 | 102 | 1,5 | 215 | 325 | 105,0 |
| 400 | 6 | 9 | 3020 | 52 | 6,75 | 146 | 370 | 38,5 |
| | 8 | 9 | 3020 | 52 | 2 | 146 | 370 | 48,0 |
| | 10 | 9 | 3535 | 89 | 16 | 178 | 370 | 57,0 |
| | 12 | 9 | 3535 | 89 | 11 | 178 | 370 | 67,0 |
| | 16 | 9 | 3535 | 89 | 1,5 | 178 | 370 | 86,0 |
| | 20 | 10 | 4040 | 102 | 1,5 | 215 | 370 | 105,0 |
| 450 | 6 | 9 | 3020 | 52 | 6,75 | 146 | 420 | 38,5 |
| | 8 | 9 | 3020 | 52 | 2 | 146 | 420 | 48,0 |
| | 10 | 9 | 3535 | 89 | 16 | 178 | 420 | 57,0 |
| | 12 | 9 | 3535 | 89 | 11 | 178 | 420 | 67,0 |
| | 16 | 9 | 3535 | 89 | 1,5 | 178 | 420 | 86,0 |
| | 20 | 10 | 4040 | 102 | 1,5 | 215 | 420 | 105,0 |
| 500 | 6 | 9 | 3020 | 52 | 6,75 | 146 | 470 | 38,5 |
| | 8 | 9 | 3020 | 52 | 2 | 146 | 470 | 48,0 |
| | 10 | 9 | 3535 | 89 | 16 | 178 | 470 | 57,0 |
| | 12 | 9 | 3535 | 89 | 11 | 178 | 470 | 67,0 |
| | 16 | 9 | 3535 | 89 | 1,5 | 178 | 470 | 86,0 |
| | 20 | 9 | 5050 | 127 | 11 | 267 | 470 | 105,0 |
| 630 | 6 | 9 | 3020 | 52 | 6,75 | 146 | 600 | 38,5 |
| | 8 | 9 | 3020 | 52 | 2 | 146 | 600 | 48,0 |
| | 10 | 9 | 3535 | 89 | 16 | 178 | 600 | 57,0 |
| | 12 | 9 | 3535 | 89 | 11 | 178 | 600 | 67,0 |
| | 16 | 9 | 4040 | 102 | 8 | 215 | 600 | 86,0 |
| | 20 | 9 | 5050 | 127 | 11 | 267 | 600 | 105,0 |
| 800 | 6 | 9 | 3535 | 89 | 25,2 | 178 | 770 | 38,5 |
| | 8 | 9 | 3535 | 89 | 20,5 | 178 | 770 | 48,0 |
| | 10 | 9 | 4040 | 102 | 22,5 | 215 | 770 | 57,0 |
| | 12 | 9 | 4040 | 102 | 17,5 | 215 | 770 | 67,0 |
| | 16 | 9 | 5050 | 127 | 20,5 | 267 | 770 | 86,0 |
| | 20 | 9 | 5050 | 127 | 11 | 267 | 770 | 105,0 |

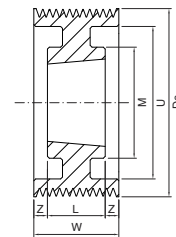

5

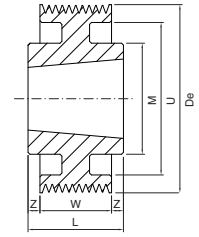

6

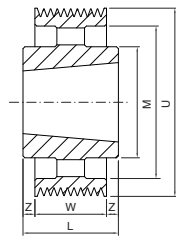

9

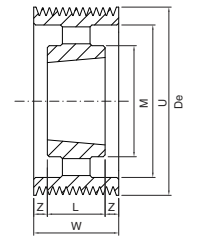

10